

303

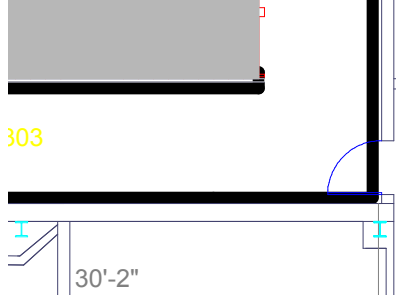

**Mahalia Jackson Theatre
Lobby - M2 Level
6' Diameter Tables
10 Chairs per Table
Seats 70 persons**

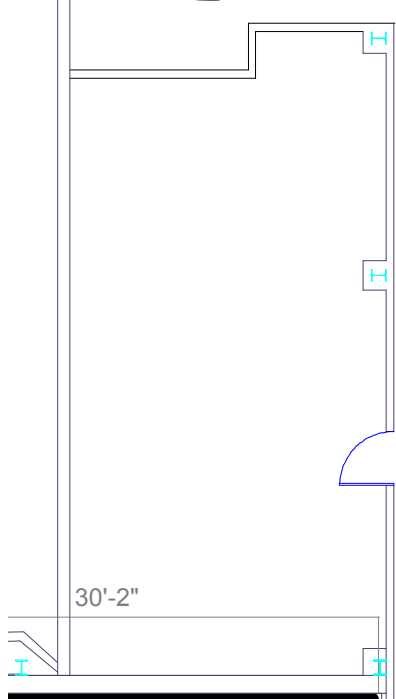
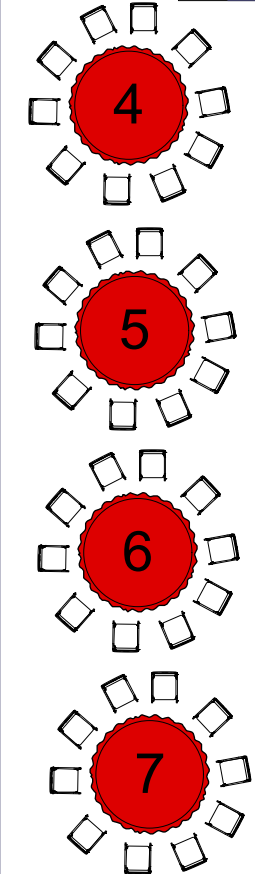
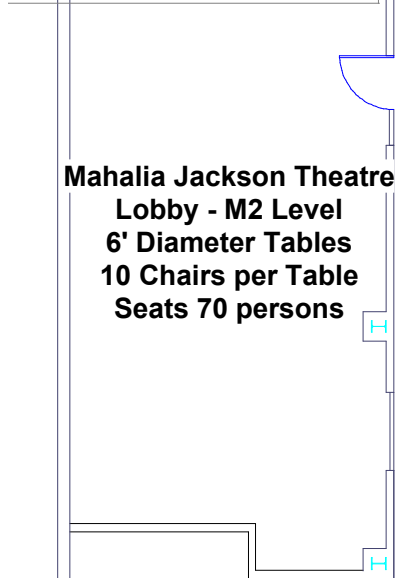

302

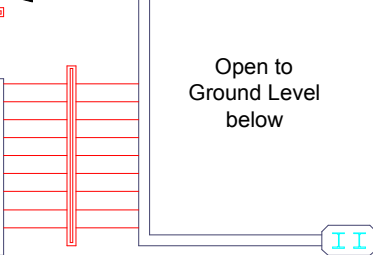
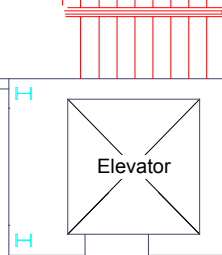

Open to
Ground Level
below

M2 Level



Ground

M2 Level

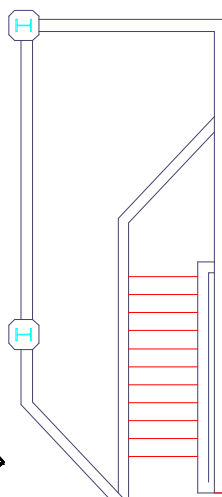

Open to Lobby below
and windows overlooking
Louis Armstrong Park

M1 Level

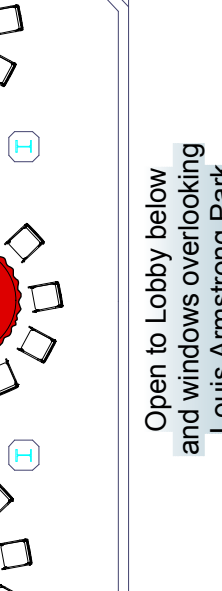

Ground

M2 Level

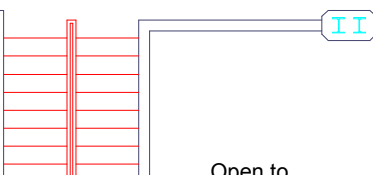
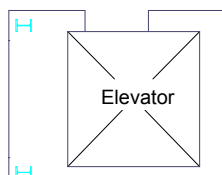

Open to
M1 "Peninsula"
below

Stairs up to M3

DN
EL. 11'-6"

M1

EL. 11'-6"
DN

